

## DRIVER'S DOOR WINDOW GOES DOWN DURING AUTO UP OPERATION

### CIRCUIT DESCRIPTION

The power window regulator master switch assembly controls the driver's power window. With the limit switch ON, when the pulse change in the pulse sensor that detects the motor revolution within the operation range of the jam protection, it is recognized as something being caught and so the motor operation will be recessed. This also occurs when the limit switch OFF position and the door glass full-closed position are not in place by replacing and installing the motor. If this occurs, reset the driver's power window regulator motor (initial position setting of the limit switch).

### WIRING DIAGRAM

[See page 05-616](#)

### INSPECTION PROCEDURE

#### 1 CHECK SLIDING RESISTANCE AT REVERSING POSITION

- (a) Turn the ignition switch ON.
- (b) Check the point that the sliding resistance of the door glass increases around the reverse position when operating the AUTO UP function.

NG

REPAIR OR REPLACE APPLICABLE PART

OK

#### 2 CHECK SLIDING RESISTANCE OF DOOR GLASS

- (a) Remove the window regulator.
- (b) When raising the assembled door glass by hand, the glass slides smoothly without being caught.

NG

REPAIR OR REPLACE APPLICABLE PART

OK

#### 3 CHECK FRONT DOOR WINDOW REGULATOR SUB-ASSY LH

- (a) Remove the power window regulator motor from the window regulator.
- (b) Check the movement of the window regulator is smooth without being caught and no damage exists in the gear part when moving the window regulator by hand.

NG

REPLACE FRONT DOOR WINDOW  
REGULATOR SUB-ASSY LH

OK

## 4 CHECK POWER WINDOW REGULATOR MOTOR ASSY LH

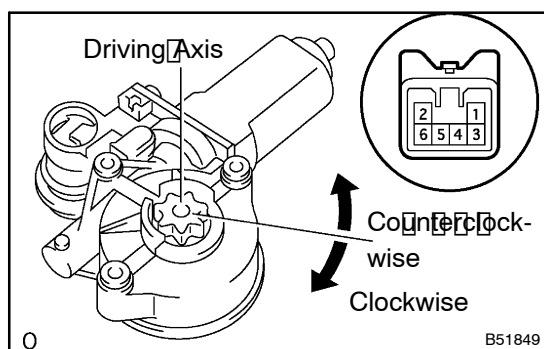

(a) Inspect the operation of the rear LH power window regulator motor assembly.

- (1) Check that the motor operates smoothly when the battery voltage is applied to each terminal of the connector.

### Standard:

Measuring condition	Operational direction
Battery positive - Terminal 4 Battery negative - Terminal 5	Clockwise rotation toward driving axis
Battery positive - Terminal 5 Battery negative - Terminal 4	Counterclockwise rotation toward driving axis

(b) Inspect operation of PTC inside power window regulator motor.

### NOTICE:

**Work must be done with the power window regulator and door glass installed to the vehicle.**

- (1) Set a TOYOTA electrical tester DC400A probe to the wire harness of terminal 4 or 5.

### NOTICE:

**Match the arrow mark of the probe with the current direction.**

- (2) Close the door glass fully.  
 (3) When approximately 60 seconds has elapsed after the door glass fully closed, check the changing time of the current, from 16 - 34 A into 1 A, when the power window regulator switch turned UP once again (inspection of current cut-off).

### Standard: Approximately 4 - 90 seconds

- (4) When approximately 60 seconds has elapsed after the inspection of the current cut-off, check that the door glass goes down when the power window regulator switch turned DOWN.

NG

**REPLACE POWER WINDOW REGULATOR MOTOR ASSY LH**

OK

## 5 RESET POWER WINDOW REGULATOR MOTOR (See page 75-6)

NG

**REPLACE POWER WINDOW REGULATOR MASTER SWITCH ASSY**

OK

**NORMAL**